

 KTR Kupplungstechnik GmbH D-48407 Rheine	Foot flange mounting instructions		KTR-N 41011 E
			sheet: 1
			edition: 2

Foot flanges serve as supporting element for the combination electro motor without foot in connection with bellhousing and hydraulic pump.

General Hints

Please read through these mounting instructions carefully before you assemble the foot flange. Please pay special attention to the safety instructions!

The mounting instructions are part of your product. Please keep them carefully and close to the foot flange.

The copyright for these mounting instructions remains with **KTR** Kupplungstechnik GmbH.

Safety and Advice Hints



DANGER!

Danger of injury to persons.



CAUTION!

Damages on the machine possible.



ATTENTION!

Pointing to important items.

General Hints to Danger



DANGER!

With assembly and disassembly of the foot flange it has to be made sure that the entire drive train is protected against unintentional engagement. You can be seriously hurt by rotating parts. Please make absolutely sure to read through and observe the following safety instructions.

- All operations on and with the foot flange have to be performed taking into account "safety first".
- Please make sure to disengage the power pack before you perform your work at the foot flange.
- Protect the power pack against unintentional engagement, e. g. by providing hints at the place of engagement or removing the fuse for current supply.
- Do not touch the operation area of the machine as long as it is in operation.
- Please protect the rotating drive parts against unintentional touch. Please provide for the necessary protection devices and caps.

Proper Use

You may only assemble and disassemble the foot flange if you

- have carefully read through the mounting instructions and understood them
- and if you are authorized and have proper skills

The foot flange ring may only be used in accordance with the technical data (see hydraulic components catalogue). Unauthorized modifications on the foot flange design are not admissible. We do not take any warranty for resulting damages. To further develop the product we reserve the right for technical modifications.

The **foot flange** described in here corresponds to the technical status at the time of printing of these mounting instructions.

Schutzvermerk ISO 16016 beachten.	Gezeichnet: 07.07.04 Sha/Bet	Ersatz für: KTR-N vom 03.01.02
	Geprüft: 07.07.04 Sha	Ersetzt durch:



The foot flange is generally supplied ready for assembly.

Components of Foot Flange

Component	Quantity	Designation
1	1	foot flange PTFL or PTFS

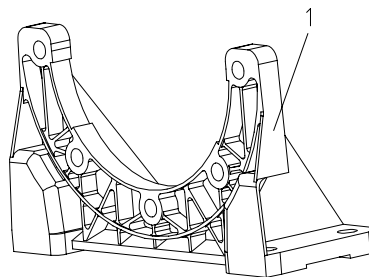

picture 1: foot flange PTFL

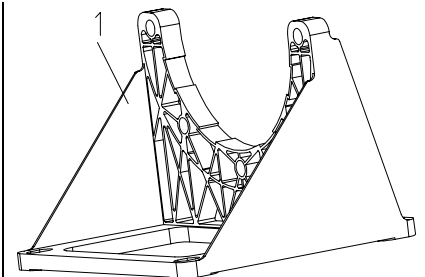

picture 2: foot flange PTFS

Assembly Bellhousing with Foot Flange

- The bellhousing is hung into the foot flange with its external centering ($\varnothing B3$).

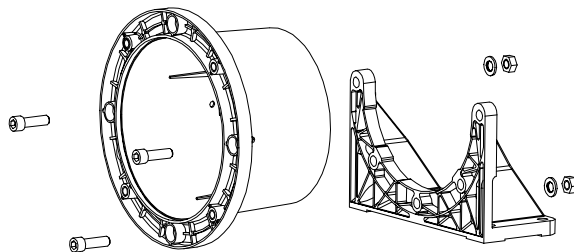

picture 3: combination bellhousing-foot flange PTFL

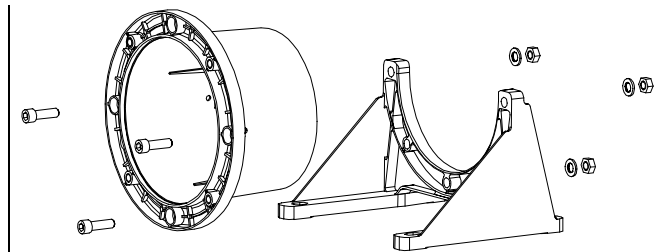

picture 4: combination bellhousing-foot flange PTFS

- Put the cap screws according to DIN 912 into the through holes of the bellhousing and the foot flange and screw both parts with a nut according to DIN 985 and a disk according to DIN 125 or comparable. You can find the screw tightening torques in table 1.

Table 1:

cap screw DIN 912 ¹	M8	M10	M12	M16	M20
tightening torque ²	25 Nm	49 Nm	86 Nm	210 Nm	410 Nm

¹min. property class 8.8

²tightening torques of the property class 8.8



ATTENTION!

The screws must be generally used with Loctite, Omnifit 230M or comparable adhesives for securing.



CAUTION!

In order to achieve the full loading capacity of the foot flanges, **all** existing fastening bores must be screwed with the bellhousing.

Further Information

Assembly of the bellhousing-foot flange combination with the electric motor and pump see KTR-N 41010 „Mounting instructions bellhousing“.

Schutzvermerk ISO 16016 beachten.	Gezeichnet: 07.07.04 Sha/Bet Geprüft: 07.07.04 Sha	Ersatz für: KTR-N vom 03.01.02 Ersetzt durch:
--------------------------------------	---	--